



412967600

EPSON®
EXCEED YOUR VISION

Useful Functions for Smart Devices

Making Printer Settings from your Smart Device

An application (Epson TM Utility) is provided that allows you to make printer settings. You can setup wireless connection from your smart device directly without having to use cables or a computer. Epson TM Utility is an application that allows you to make a variety of settings and perform test printing from an iOS/Android device.

Setting Up a Wireless Connection Using the Wizard

The wizard provided allows you to easily connect to smart devices.

Prepare the following items.

- Device to be set up: iOS or Android device
- Utility used for set up: Epson TM Utility for iOS or Epson TM Utility for Android

Note

You can download the Epson TM Utility from Google Play™ or the App Store.



When using a wireless LAN interface

1. Run the Epson TM Utility.
2. Select "Wi-Fi® Setup Wizard" from the menu.
3. See the Epson TM Utility on-screen guide to make settings and perform operations.

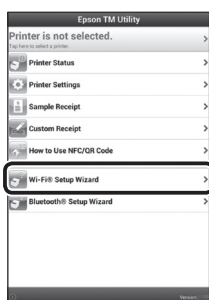

Setup and Operation Work flow

Select the network you want to connect to.

Enter the passkey.

Perform a test print.

When using a Bluetooth® interface

1. Run the Epson TM Utility.
2. Select "Bluetooth® Setup Wizard" from the menu.
3. See the Epson TM Utility on-screen guide to make settings and perform operations.

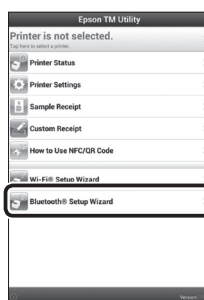

Setup and Operation Work flow

Select the printer you want to connect to.

Enter the passkey.

Perform a test print.

EPSON is a registered trademark of Seiko Epson Corporation.

Exceed Your Vision is a registered trademark or trademark of Seiko Epson Corporation.

Wi-Fi® is a registered trademark of Wi-Fi Alliance®.

The Bluetooth® word mark and logos are registered trademarks owned by Bluetooth SIG, Inc. and any use of such marks by Seiko Epson Corporation is under license.

IOS is a trademark or registered trademark of Cisco in the U.S. and other countries and is used under license.

Android and Google Play are trademarks of Google, Inc.

QR Code is a registered trademark of DENSO WAVE INCORPORATED in Japan and in other countries.

All other trademarks are the property of their respective owners and used for identification purpose only.